

ALL BURRS AND SHARP EDGES MUST BE REMOVED. ALL DIMENSIONS IN mm

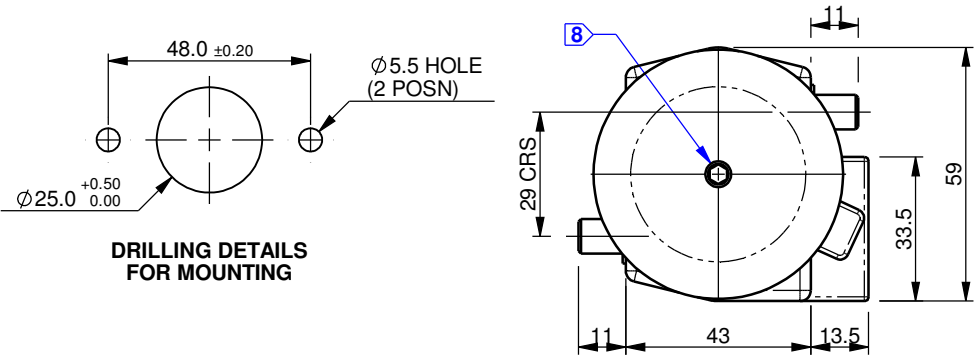

OPERATING MODES FOR...

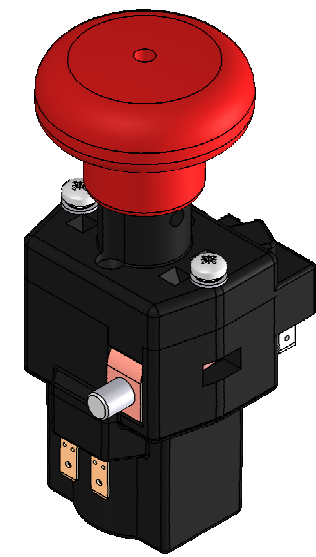
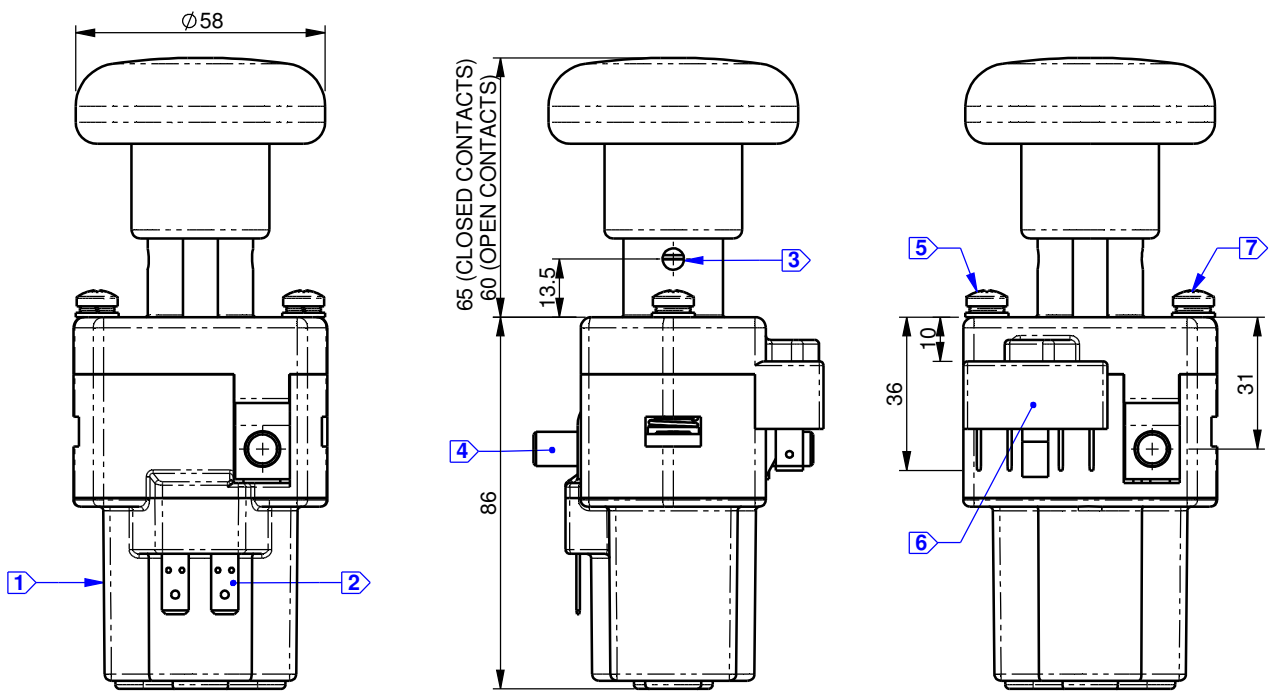
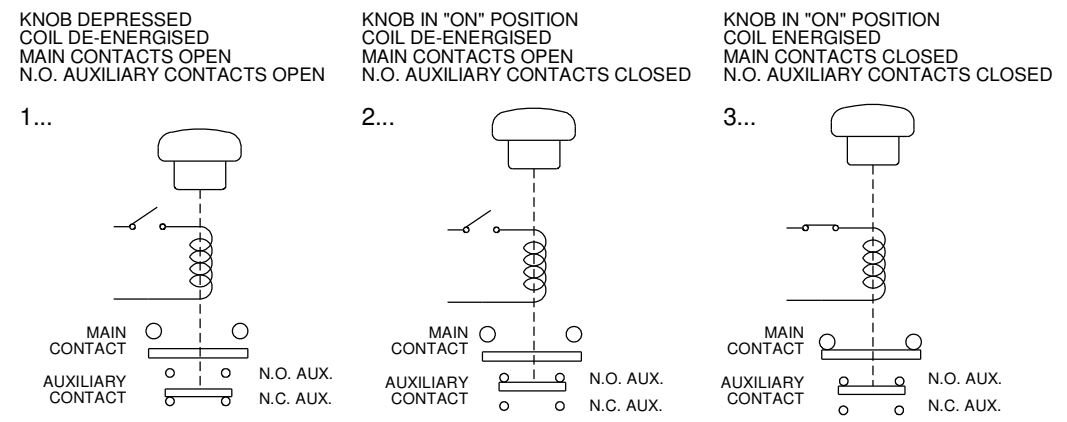

- 1 SWITCH IDENTITY LABEL FITTED ON LEFT HAND SIDE
- 2 6.3mm SPADE TERMINALS FOR COIL CONNECTIONS
- 3 Ø 5.0 HOLE FOR TIGHTENING KNOB (HOLE EXPOSED WHEN KNOB IS IN UPPER POSITION)
- 4 M8 TERMINALS TO BE TORQUED WITHIN RANGE 7-8Nm (62-70.8 lbf/inch)
- 5 M5 FIXING SCREWS FOR MOUNTING SHOULD BE TIGHTENED TO A TORQUE WITHIN RANGE 1.5 - 1.7Nm (13.2 - 15 lbf/inch)
- 6 AUXILIARY CONNECTION
- 7 HARDWARE KIT 1500-029 FITTED HERE
- 8 Ø 6.0 HOLE THROUGH CENTRE OF KNOB - KNOB TO BE TIGHTENED USING A 4mm HEXAGON KEY

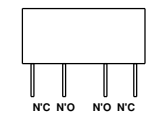

SD200A-33	24V CO.	52 Ω	16.0V max.	6.0V max	-	-
SWITCH TYPE	VOLTAGE	COIL RESISTANCE	PULL-IN VOLTS	DROP-OUT VOLTS	RESISTOR (0.25W)	DIODE

							MATERIAL	SCALE	DESCRIPTION		
							SEE INDIVIDUAL PARTS	N.T.S (DO NOT SCALE DRG.)	OUTLINE		
							FINISH	TYPE	SHEET	DRAWING No.	
							SEE INDIVIDUAL PARTS	SD200A	1 OF 1	1500-075	
08.10.09	1	1st ISSUE	NDR 0380	RR	PJD	PJD					
DATE	ISSUE	DESCRIPTION OF CHANGE	CNR No.	D'WN. BY	CK'D BY	APP'D BY					

THIS DOCUMENT CONTAINS PROPRIETARY INFORMATION OWNED BY ALBRIGHT INTERNATIONAL LTD. AND MAY NOT BE DUPLICATED OR COMMUNICATED TO OTHER PARTIES WITHOUT THE WRITTEN PERMISSION OF ALBRIGHT INTERNATIONAL LTD. 125 RED LION ROAD, TOLWORTH, SURREY, KT6 7QS, ENGLAND
 TEL: +44 (0) 20 8390 5357 FAX: +44 (0) 20 8390 1927 WEB: www.albright.co.uk EMAIL: technical@albright.co.uk



GENERAL TOLERANCE, UNLESS OTHERWISE STATED :
 ALL RADI IN CORNERS TO BE 0.13mm/0.005" MAX. TURNED FINISHES TO BE N6 OR BETTER. X.X = +/-1.0
 HOLES TO B.S. 4500 H11. CONCENTRIC DIAMETERS TO HAVE MAXIMUM T.I.R. OF 0.25mm/0.010". X.XX = +/-0.2
 METRIC THREADS TO B.S. 3643 - INTERNAL 6H, EXTERNAL 6g. IMPERIAL DIMENSIONS ±0.005" X.XX = +/- 0.08