

Low Profile Hatch

The Low Profile Hatch has soft styling and sleek looks, ideal for use on a powerboat. Smaller ventilation hatches are suitable for any deck location on sailboats, while the larger sizes can be used as foredeck hatches on smaller to mid size yachts.

- Outside handles allow the hatch to be opened from on deck if it is not locked
- Friction levers hold the lid open in any position up to 95°
- Anodised aluminium frame for corrosion resistance
- Curved upper frame for strength as well as modern styling
- CE Approved
- Available in Round and D-Hatch configuration

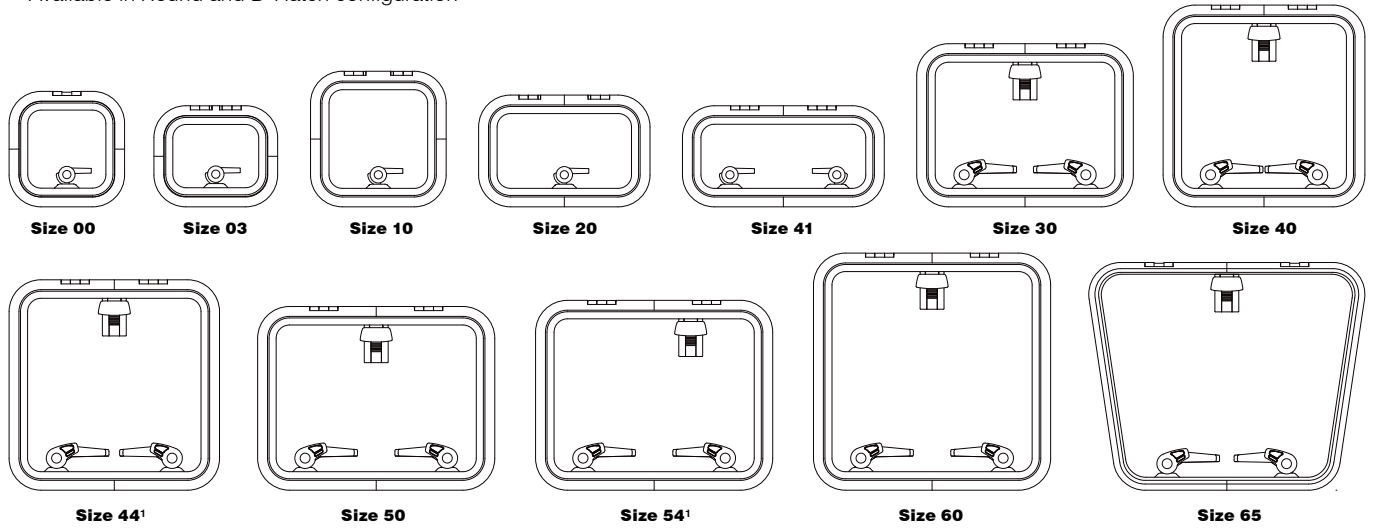

¹ Minimum size for ISO 9094 escape hatches

Low Profile Hatch Dimensions

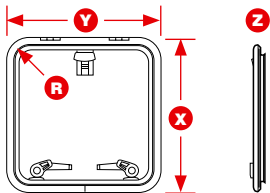

Low Profile Hatch Cut-outs

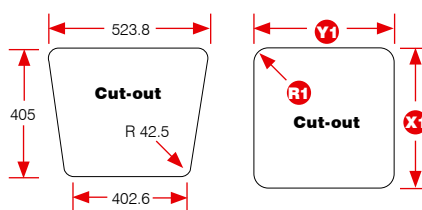

Low Profile Hatch Specifications

PART NUMBER SELF SUPPORTING LID	PART NUMBER HATCH WITH TELESCOPIC STAY	SIZE	LOWER FRAME FLANGE		OVERALL DIMENSIONS								CUT-OUT DIMENSIONS Change if Trimkits are used						HATCH WEIGHT		ACRYLIC WINDOW THICKNESS	
			mm	in	X LENGTH	Y WIDTH		Z HEIGHT		R RADII		X1 LENGTH		Y1 WIDTH		R1 RADII		kg	lb	mm	in	
						mm	in	mm	in	mm	in	mm	in	mm	in	mm	in					mm
39900030		0	15	9/16	281	11 1/16	281	1 1/16	25	1	72.5	2 7/8	211	8 5/16	211	8 5/16	42.5	1 11/16	1.6	3.5	8	5/16
39903030		3	15	9/16	246	9 1/16	301	11 7/8	25	1	72.5	2 7/8	176	6 15/16	231	9 1/8	42.5	1 11/16	1.6	3.5	8	5/16
39910030	399100303	10	15	9/16	330	13	330	13	25	1	72.5	2 7/8	260	10 1/4	260	10 1/4	42.5	1 11/16	2.2	4.9	8	5/16
39920030		20	15	9/16	272	10 11/16	417	16 7/16	25	1	72.5	2 7/8	202	7 15/16	347	13 11/16	42.5	1 11/16	2.3	5.1	8	5/16
39930030	399300303	30	15	9/16	397	15 5/8	527	20 3/4	25	1	72.5	2 7/8	327	12 7/8	457	18	42.5	1 11/16	4.2	9.3	8	5/16
39940030	399400303	40	15	9/16	491	19 3/16	491	19 3/16	25	1	72.5	2 7/8	421	16 9/16	421	16 9/16	42.5	1 11/16	4.6	10.1	8	5/16
39941030		41	15	9/16	246	9 11/16	491	19 5/16	25	1	72.5	2 7/8	176	6 15/16	421	16 9/16	42.5	1 11/16	2.5	5.5	8	5/16
39944030	399440303	44	15	9/16	512	20 3/16	512	20 3/16	25	1	72.5	2 7/8	442	17 3/8	442	17 3/8	42.5	1 11/16	4.8	10.6	8	5/16
39950030	399500303	50	15	9/16	447	17 5/8	577	22 11/16	25	1	72.5	2 7/8	377	14 13/16	507	19 15/16	42.5	1 11/16	4.8	10.6	8	5/16
39954030	399540303	54	15	9/16	462	18 3/16	577	22 11/16	25	1	72.5	2 7/8	392	15 7/16	507	19 15/16	42.5	1 11/16	4.9	10.8	8	5/16
39960030	399600303	60	15	9/16	577	22 11/16	577	22 11/16	25	1	72.5	2 7/8	507	19 15/16	507	19 15/16	42.5	1 11/16	6.4	14.1	10	3/8
39965030		65	15	9/16	560	22 11/16	560 min 675 max	22 11/16 26 9/16	25	1	72.5	2 7/8	See drawing				42.5	1 11/16	6.5	14.3	10	3/8

Low Profile Round Hatch



Telescopic Stay
Lewmar's Telescopic Stay features excellent lid positioning and rigid control. The stay allows hatch opening to around 90° – an advantage on smaller to mid size yachts where deck space is a premium.



Maintenance
Acrylic or seal can be replaced by sliding the two halves of the frame apart.

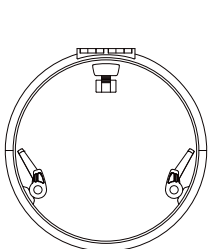

Size 18

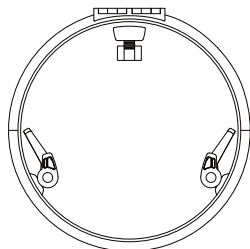

Size 22

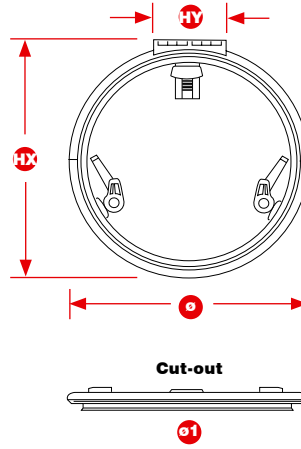

Low Profile Round Hatch Specifications

PART NUMBER	SIZE	LOWER FRAME FLANGE		OVERALL DIMENSIONS								CUT-OUT DIMENSIONS Change if Trimkits are used		HATCH WEIGHT		ACRYLIC WINDOW THICKNESS	
		mm	in	LENGTH		HEIGHT		HINGE LENGTH		HINGE WIDTH		DIAMETER		kg	lb	mm	in
39918030	18	15	9/16	490	19 15/16	25	1	493	19 7/16	141	5 9/16	420	16 9/16	3.8	8.4	8	5/16
39922030	22	15	9/16	588	23 1/8	25	1	591	23 1/4	173	6 13/16	518	20 3/8	5.8	12.8	10	3/8

Low Profile D-Hatch

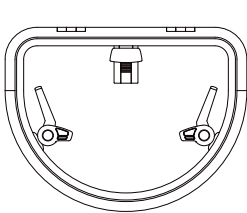

Size 51

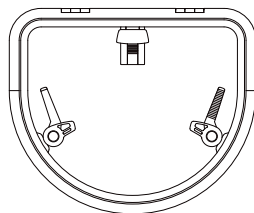

Size 64

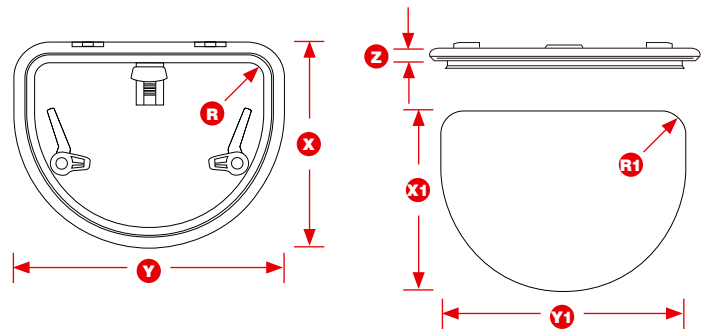

Low Profile D-Hatch Specifications

PART NUMBER SELF SUPPORTING LID	SIZE	LOWER FRAME FLANGE		OVERALL DIMENSIONS								CUT-OUT DIMENSIONS Change if Trimkits are used				HATCH WEIGHT		ACRYLIC WINDOW THICKNESS			
		mm	in	LENGTH		WIDTH		HEIGHT		RADII		LENGTH		WIDTH		RADII		kg	lb	mm	in
39951030	51	15	9/16	448	17 3/8	588	23 1/8	25	1	72.5	2 7/8	378	14 7/8	518	20 3/8	42.5	1 11/16	5.5	12.1	8	5/16
30067300	64	15	9/16	500	19 11/16	600	23 3/8	25	1	72.5	2 7/8	430	16 13/16	530	20 7/8	42.5	1 11/16	6.4	14.1	8	5/16